

Marian Regional Medical Center Campus



- 1 Main Building
 - Main Entrance (New Hospital)
 - Emergency Entrance
 - Outpatient Entrance
 - Patient Discharge
- 2 Human Resources, Education, Foundation Building
- 3 Mission Hope Cancer Center
- 4 Marian Extended Care
- 5 Marian Hancock Building
- 6 Marian Main Street Services
- 7 Marian Conference Center
- 8 Dignity Health Family Medicine Center
- Marian Perinatal Center

 **Dignity Health™**
Marian Regional Medical Center

1400 East Church Street
Santa Maria, CA
(805) 739-3000

Level 1

Radiology/Chapel/Emergency Department/Lab

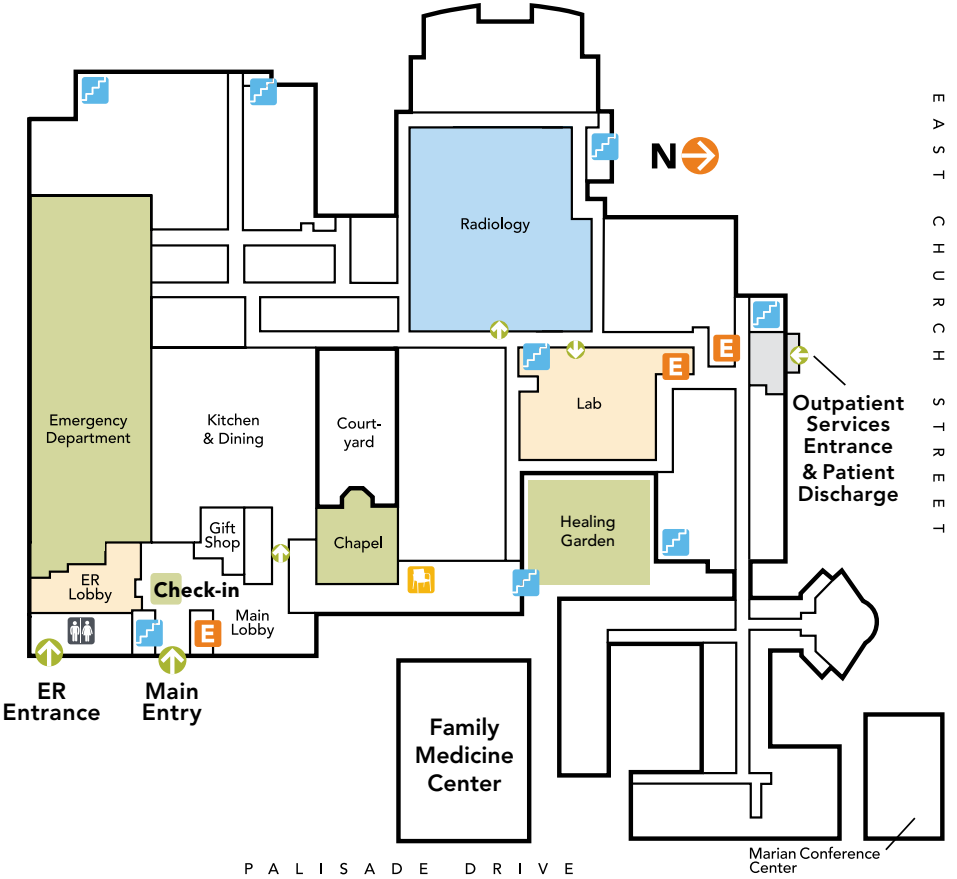

EAST CHURCH STREET

PALISADE DRIVE

- Restrooms
- Stairs
- Elevators
- Nurses' Station
- Waiting Area
- Entry

Level 2

Surgery/Critical Care Unit/Telemetry

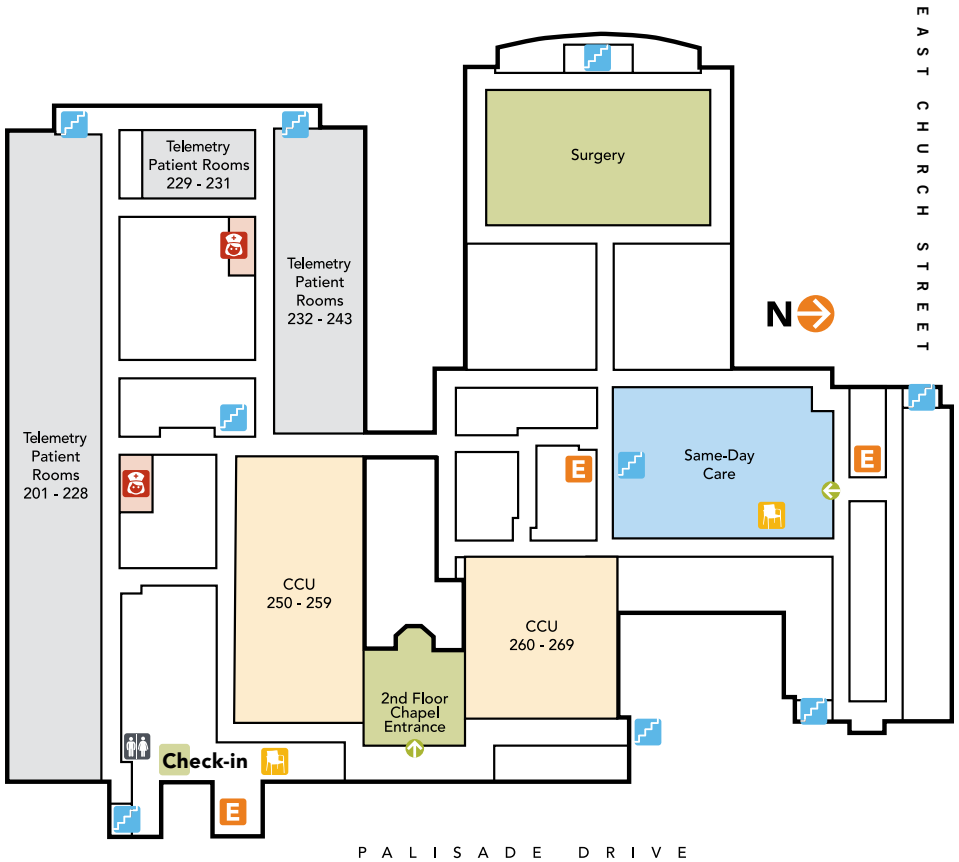





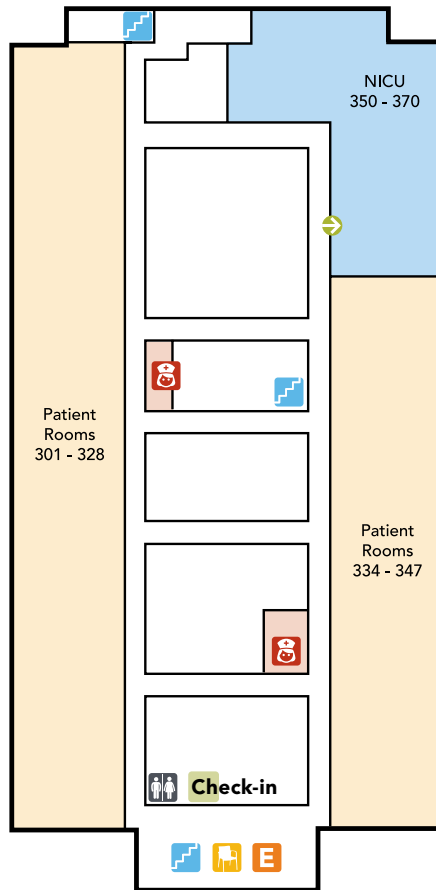

- Restrooms
- Stairs
- Elevators
- Nurses' Station
- Waiting Area
- Entry

Level 3 Perinatal Services

Labor and Delivery/Mother Baby Care/Newborn ICU



P A L I S A D E D R I V E





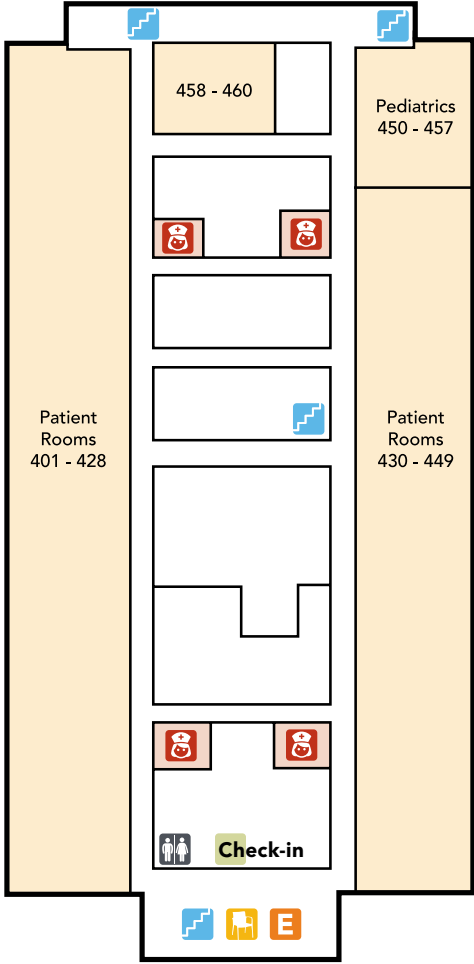

-  Restrooms
-  Stairs
-  Elevators
-  Nurses' Station
-  Waiting Area
-  Entry

Level 4

Medical Surgical/Pediatrics/Pharmacy



P A L I S A D E D R I V E

-  Restrooms
-  Stairs
-  Elevators
-  Nurses' Station
-  Waiting Area
-  Entry

Parking Lots

For Marian Patients and Guests

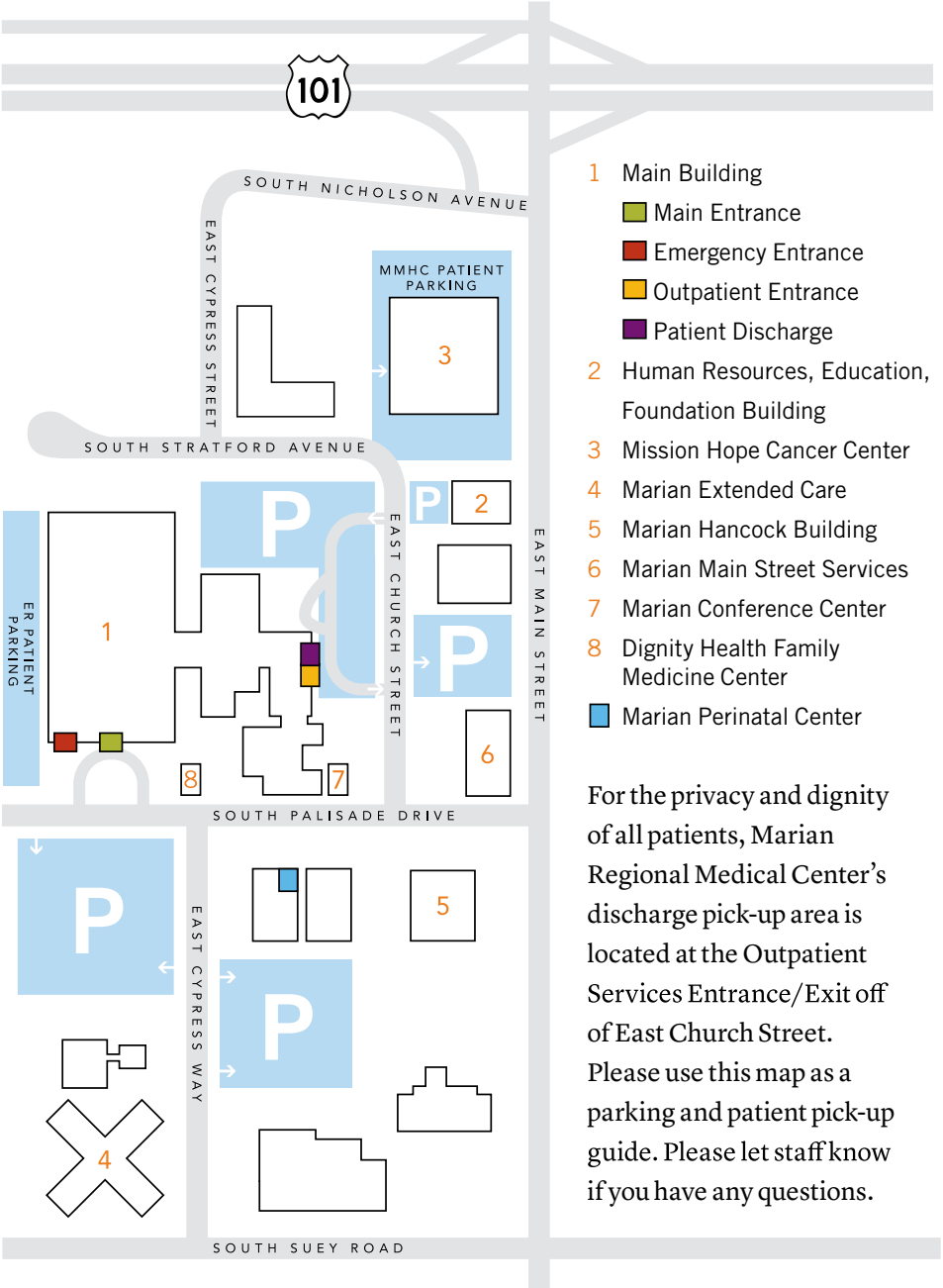

- 1 Main Building
 - Main Entrance
 - Emergency Entrance
 - Outpatient Entrance
 - Patient Discharge
- 2 Human Resources, Education, Foundation Building
- 3 Mission Hope Cancer Center
- 4 Marian Extended Care
- 5 Marian Hancock Building
- 6 Marian Main Street Services
- 7 Marian Conference Center
- 8 Dignity Health Family Medicine Center
- Marian Perinatal Center

For the privacy and dignity of all patients, Marian Regional Medical Center’s discharge pick-up area is located at the Outpatient Services Entrance/Exit off of East Church Street. Please use this map as a parking and patient pick-up guide. Please let staff know if you have any questions.